

# John Wright Modelmaking

The price list shows pictures of joints at actual size. The size reference (3mm-12mm) is the actual ball size. The balls come pre-drilled & are made from a hardened stainless steel.

The joint plates are machined from stainless steel stock. Joints do not come pre soldered.

A ball & socket unit comprises of 2 machined steel plates, a tension screw, pre drilled stainless balls.

We recommend only hard (silver) solder to be used in joining stainless steel.

All joints are usually in stock & are dispatched on receipt of payment. A 10% discount is offered to students. For Quotes & more information Please contact our studio.

We also offer a full armature design & construction service & have produced armatures for studios around the world.

By simply e-mailing an out line drawing of your character,

we can provide you with an armature design for your approval.

This design process can be completed within a couple of hours.

After approval, the construction of an armature can be completed within 1 week depending on work loads.

Prices start at around £650.



3mm double £14.85 extra balls £2.20  
1/16" diameter rod 15cm long £0.42

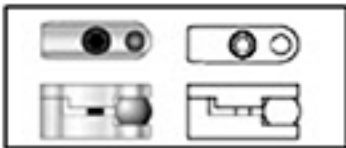

5mm single £12.65 extra balls £2.64  
3/32" diameter rod 15cm long £0.50

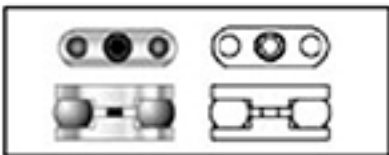

5mm double £15.29 extra balls £2.64  
3/32" diameter rod 15cm long £0.50

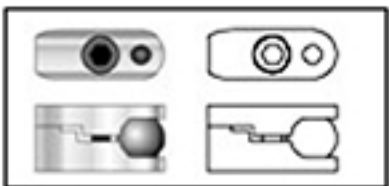

6mm single £15.40 extra balls £2.92  
3/32" diameter rod 15cm long £0.50

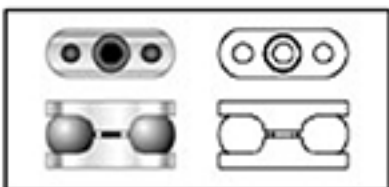

6mm double £18.32 extra balls £2.92  
3/32" diameter rod 15cm long £0.50

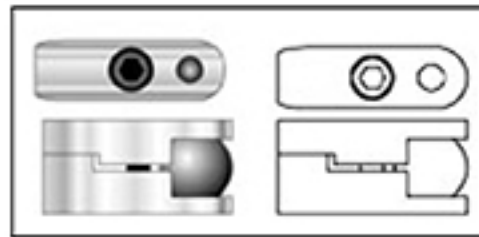

9mm single £18.70 extra balls £3.74  
1/8" diameter rod 15cm long £0.55

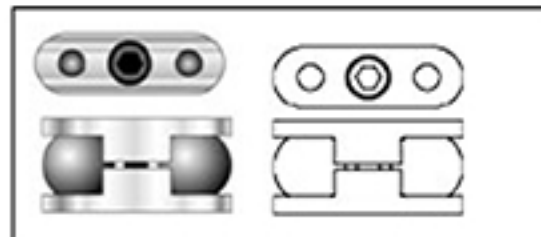

9mm double £22.44 extra balls £3.74  
1/8" diameter rod 15cm long £0.55

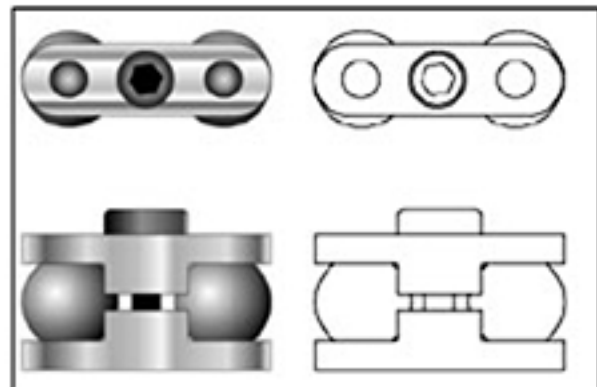

12mm double £27.94 extra balls £4.11  
5/32" diameter rod 15cm long £0.60